



HOMELESSNESS SERVICES & RESPITE SITES

COVID-19 SERVICE STRATEGIES

FOR MORE INFORMATION CONTACT
EMRESPONSE@BLTCONSTRUCTION.COM



SAFETY FIRST

COVID-19 PREVENTION
MEANS PROVIDING
HOMELESSNESS
SERVICES WITH
FACILITIES WHERE
PHYSICAL DISTANCING
IS POSSIBLE.

Reconfiguring homelessness service for the pandemic means developing new temporary shelter and respite centre layouts.

Our team at BLT Construction Services believes that the safety challenges faced by homelessness service providers and people experiencing homelessness can be addressed with a flexible and temporary solution that supports operations without compromising safety and wellbeing.



TURNKEY BUILDING SOLUTION

In partnership with Sprung Structures, BLT Construction Services has developed a turnkey solution that can effectively address the requirements for temporary shelter and respite sites.

With the ability to accommodate any site requirement and occupancy, these scalable structures can be customized to suit specific requirements.

RAPID BUILD
STRUCTURES THAT
OFFER AN UNMATCHED
LEVEL OF VERSATILITY,
LONGEVITY, AND
PORTABILITY.



KEY BENEFITS

- » Our experienced team at BLT can provide expert site analysis, planning, complete design services, and manage all elements of the project.
- » Our solution can provide you with a rapid deployment strategy with an expertly led installation process.
- » Highly customizable structures with options for insulation, power plants, mechanical systems, and lighting options.
- » Potential for accelerated tax depreciation compared to traditional buildings.

SPECIFICATIONS

Sprung Structures are a quick build, performance architectural solution.

- » With R-25 insulation capabilities, they are highly capable in, and comfortable for, Canadian winters.
- » Performance architectural membrane prevents solar gain, is energy efficient, and suitable for hospital-grade applications. The standard Polyurethane Architectural Membrane has a 15-year pro-rata guarantee, with the option to upgrade to a DuPont™ Tedlar® Membrane for added longevity, further colour choices, and a 25-year pro rata guarantee.
- » Rust-proof and long-lasting aluminum military grade substructure comes with a 50-year pro-rata guarantee from Sprung.



CASE STUDY

CITY OF TORONTO 24-HOUR RESPITE SITES

DESIGN-BUILD OF
THREE 60' x 150'
SPRUNG STRUCTURES,
EACH DELIVERED ON
A TIGHT DEADLINE.

BUILDING SERVICES

- » R-25 insulation
- » All-season HVAC system with heating and cooling
- » Sprinkler and Fire Alarm system
- » Full-length daylight ceiling panels to provide natural light
- » Lighting system with dimmer controls
- » Industrial ceiling fans

LOCATIONS

- » 69 Fraser Ave. Opened: Dec 2018 / Capacity: 100 spaces
- » 1A Strachan Ave. Opened: May 2019 / Capacity: 100 spaces
- » 351 Lakeshore Blvd. E. Opened: Apr 2019 / Capacity: 100 spaces

AMENITIES

Each 24-Hour Respite Site structure has a building footprint of 9,000 sq ft, with capacity for 100 clients in a pre-pandemic setting. These Respite Sites include:

- » Reception and Security Station
- » Served and Storage Area with industrial dishwasher and sink
- » Dining Area with Built-in Charging Stations and TV
- » Counselling Room
- » Washroom and Shower Facilities with barrier-free facilities, universal facilities, and designated gender neutral facilities
- » Laundry Facilities
- » Exterior space designated for Smoking and Pet Areas
- » Staff Facilities including Office at mezzanine level and barrier-free washrooms



TEMPORARY SHELTER FACILITY



60' x 150' TEMPORARY SHELTER FACILITY

66 PERSON OCCUPANCY

*For illustrative purposes only, spaces will be configured per requirements

BLT 

Implement screening protocols for building entry and exit

As a preventative first-line defense, active screening for all people entering on-site facilities should be implemented at entry into, and exit from, the facilities.



BLT 



Physical Distancing Controls

Physical distancing requirements are built into the space with 6 ft wide aisles, and a reconfigurable dining area that can provide overflow space.

Movable wall partitions provide physical barriers between resting spaces.

BLT 

TEMPORARY SHELTER FACILITY

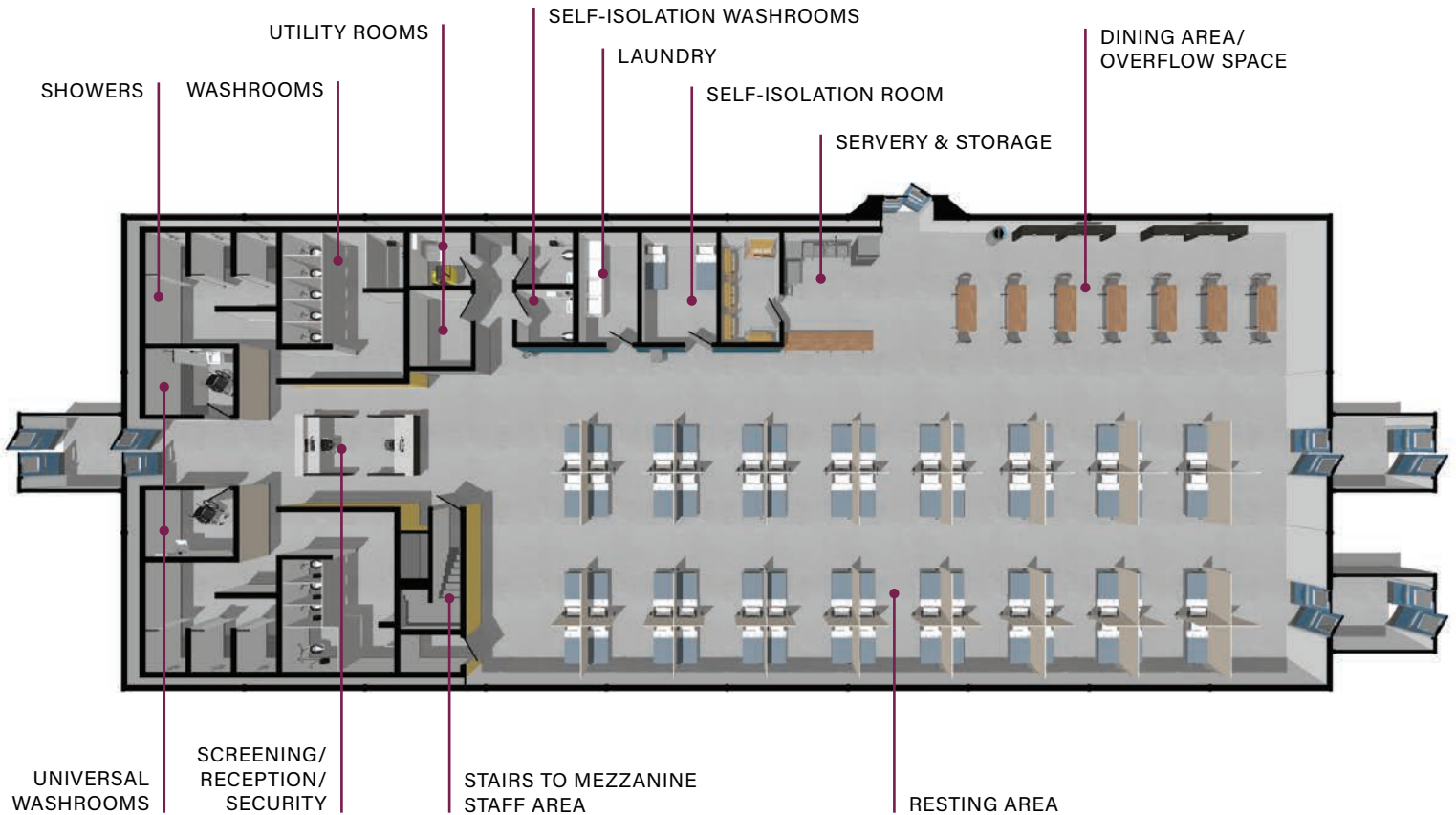

OVERALL FLOOR PLAN

SECTION



60' x 150' TEMPORARY RESPITE

66 PERSON OCCUPANCY

*For illustrative purposes only. Space will be configured per requirements.

BLT
CONSTRUCTION SERVICES



FOR MORE INFORMATION CONTACT
EMRESPONSE@BLTCONSTRUCTION.COM

